

050 - Interior Trim/200 - Panels-Moldings-Scuff Plates, Pillar, Cowl, 1/4 Panel Trim and Cargo Covers

DESCRIPTION

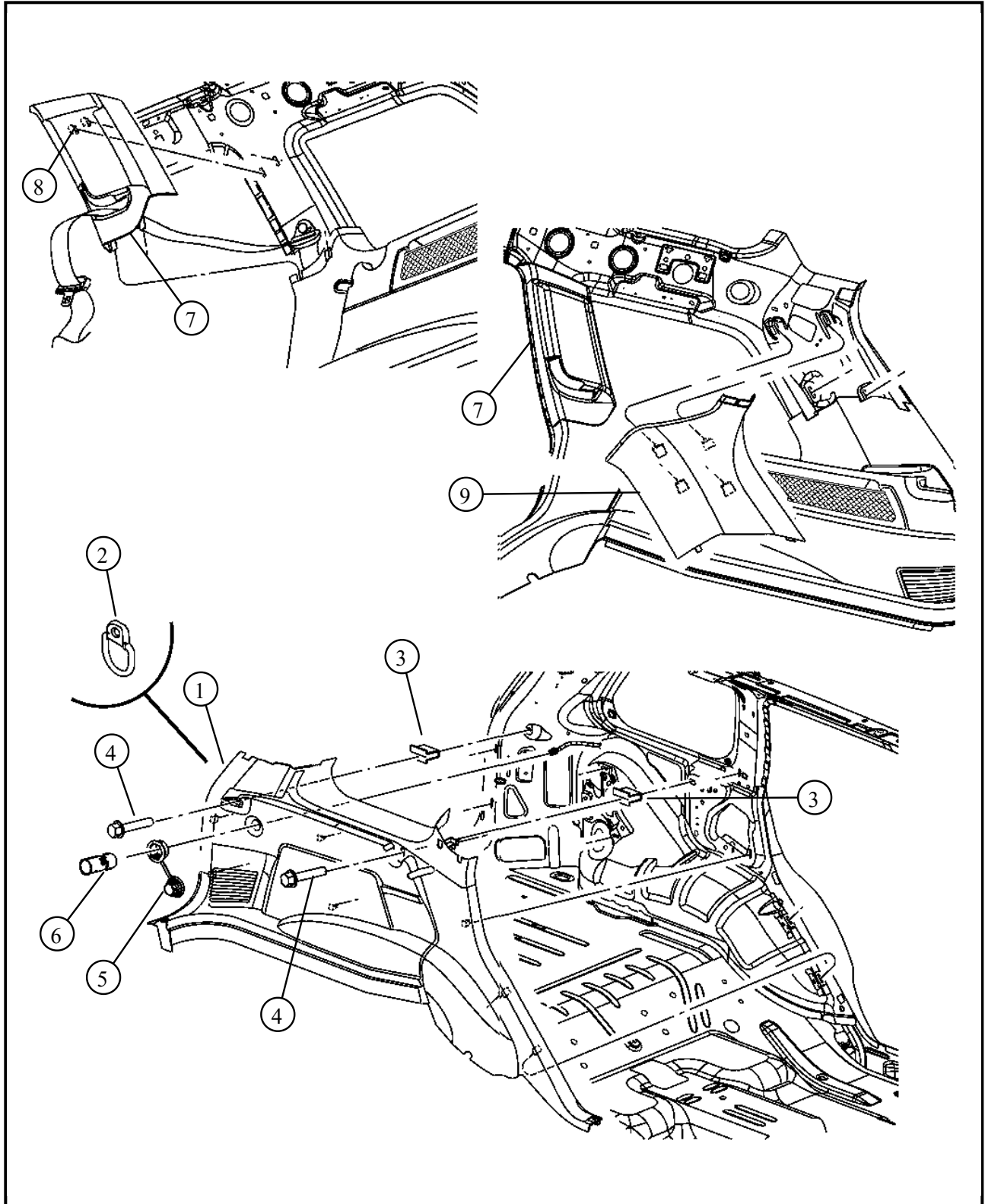

Item	Description	Part Number	Qty	Supersedece	Tech Tip	Engine	Trans	Line	Body
1	PANEL, Quarter Trim								
	Left, [DV]	1CL991DVAA	1	Yes					
	PANEL	1CL991DVAB	0	Yes					
	PANEL	1CL991DVAC	1	Yes					
	Right, [DV]	5HS361DVAH	1	Yes					
	PANEL	5HS361DVAI	1	Yes					
2	LOOP, Cargo Tie Down	55196901AB	1	No					
3	NUT	06035773	2	No					
4	SCREW, Tapping Hex Head, M4.2X1.70X20.00								
		06101946	8	No					
		06101946	2	No					
		06101946	8	No					
		06101946	4	No					
5	MOUNT, Power Outlet								
		04685668AA	1	No					
		04685668AA	1	No					
6	POWER OUTLET								
		04793554AC	1	No					
		04793554AC	1	No					
		04793554AC	1	No					
7	MOLDING, C Pillar								
	Right	5HS34BDXAH	1	Yes					
	MOLDING	5HS34BDXAI	1	Yes					
	Left	5HS35BDXAH	1	Yes					
	MOLDING	5HS35BDXAI	1	Yes					
8	PLUG, C Pillar								

Item	Description	Part Number	Qty	Supersedence	Tech Tip	Engine	Trans	Line	Body
	Right	1CL22BDXAA	1	No					
	Left	1CL23BDXAA	1	No					
9	MOLDING, D Pillar								
	Right	5HS30XDVAH	1	No					
	Right, All Interior Trim Color Codes	5HS30BD1AH	1	Yes					
	MOLDING	5HS30BD1AI	1	Yes					
	Left	5HS31XDVAH	1	No					
	Left, All Interior Trim Color Codes	5HS31BD1AH	1	Yes					
	MOLDING	5HS31BD1AI	1	Yes					

Note: The item number that is listed in negative(-) indicates there is no illustration available.